



**BEAUTIFUL
EVENTS
ARE IN OUR
NATURE**



MISSOURI
BOTANICAL
GARDEN

SPECIAL EVENT AND MEETING VENUES

Welcome to the area's most beautiful, distinctive, and versatile event space, located in the heart of Saint Louis at the modern, yet historic, Missouri Botanical Garden.

Here, you'll discover an idyllic blend of natural splendor and state-of-the-art facilities, making us a picture-perfect location for any gathering—from lavish weddings to sophisticated corporate events to small, intimate meetings.

At the heart of our offerings, you'll find our stunning Jack C. Taylor Visitor Center, where you can create the occasion of your dreams, regardless of your vision or the size of your event. We also offer delightful historic venues, all surrounded by natural elegance unrivaled anywhere in the region.

As an organization rooted in the beauty of nature, sustainability, and hospitality, we love nothing more than helping your hopes for a memorable event come to fruition. With our planning expertise and dedication to follow-through, you can count on us to make your special occasion blossom into an unforgettable event.

CONTENTS

BAYER EVENT CENTER	2
1. Centene Event Hall 2. Orthwein Event Center Lobby 3. Maritz Event Foyer 4. Kooyumjian Family Event Terrace	
JACK C. TAYLOR VISITOR CENTER	10
5. Lelia J. and David N. Farr Auditorium 6. East and West Meeting Rooms 7. William T. Kemper Lobby 8. Sasafress Restaurant and the Bellwether Café	
SPINK PAVILION	22
WEDDING VENUES	25
9. Lehmann Rose Garden 10. Gladney Rose Garden 11. Blanke Boxwood Garden 12. Grigg Nanjing Friendship Chinese Garden 13. Japanese Garden 14. Linnean Plaza	
CONTACT	28



BAYER EVENT CENTER

At the heart of our meeting and event offerings is the modern, world-class Bayer Event Center. This breathtakingly modern space offers something for everyone, from large venues for weddings and corporate events to sleek, state-of-the-art meeting rooms for smaller gatherings. Regardless of your specific needs, you and your guests will be treated to expansive views of our natural surroundings and garden landscapes.

Boasting a private entrance and a large, airy lobby, Bayer Event Center also features an elegant pre-function area for receptions, a bar area, and coat check. You'll appreciate the ample parking, private restroom, and optional customizable digital signage.

Consisting of both large and small spaces, Bayer Event Center is incredibly versatile. So, no matter what size event you're hosting, or what mood you hope to set, one of the areas in this remarkable building is sure to deliver the perfect expression of your wishes.



CENTENE EVENT HALL

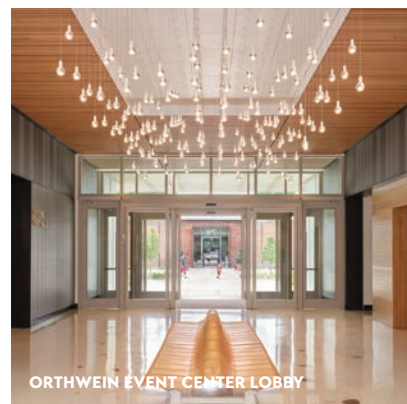

ORTHWEIN EVENT CENTER LOBBY



MARITZ EVENT FOYER



KOORYUMJIAN FAMILY EVENT TERRACE





Separate rental fee required for some decor and seating.



CENTENE EVENT HALL

Designed with ultimate functionality in mind, the highlights of this meeting hall include customizable lighting, a charming bridal dressing room, and an easy-access loading dock for any event type and entertainment needs.

SQUARE FEET: 5,378

Partitioned Room A: 2,624sf
Partitioned Room B: 2,750sf

CAPACITY: 450

Seated: 330
Buffet Seated: 250
Buffet Cocktail: 450

Seated and buffet seated events are calculated using 66-inch round tables with 10 guests at each.

AVAILABILITY

Day Facility Rental

Monday–Friday: \$2,000
Saturday–Sunday: \$4,000

Evening Facility Rental

Monday–Thursday: \$3,500
Friday–Sunday: \$4,000*

* Includes entire venue plus a large outdoor patio for entertaining on the award-winning grounds. Access to Garden grounds not included.

LIGHTING

Color choices and art projection available

AUDIO/VISUAL

Technology capabilities and support available

GREEN ROOM

Can also be used as a bridal dressing room

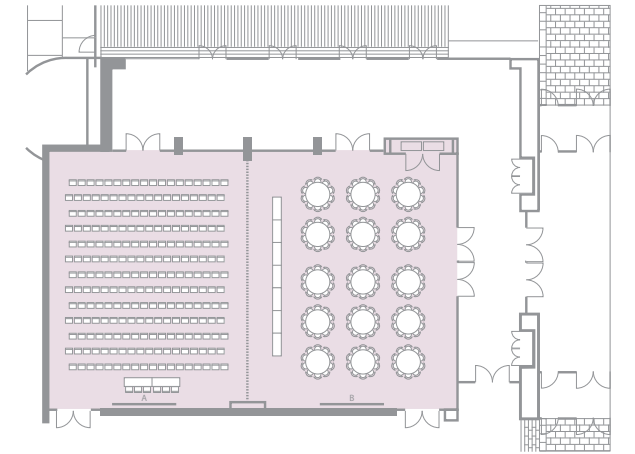



ORTHWEIN EVENT CENTER LOBBY

This spacious entryway affords easy check-in for large gatherings, with customizable digital displays and dedicated access to our outdoor event terrace.



MARITZ EVENT FOYER

This gorgeous open space features direct access to our outdoor terrace and is the perfect place for your pre-event reception or cocktail hour.



KOORYUMJIAN FAMILY EVENT TERRACE

Adjacent to the Maritz Foyer and great for inviting the Garden into your event, this spacious outdoor plaza offers inspiring views of biodiversity-rich garden beds.

Access to Garden grounds not included.



Separate rental fee required for some decor and seating.

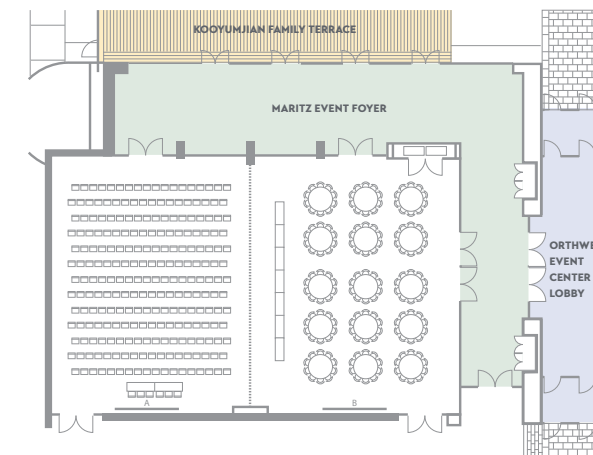



Separate rental fee required for some decor and seating.

JACK C. TAYLOR VISITOR CENTER

The Jack C. Taylor Visitor Center is a place of welcome and a portal to the Missouri Botanical Garden. Here, technology and nature work in harmony to provide a world-class guest experience. Multi-tiered entry gardens lead to a soaring lobby filled with dappled natural light, and arresting views of gardens and conservatories await just a few steps away.



LELIA J. AND DAVID N. FARR AUDITORIUM



MEETING ROOMS

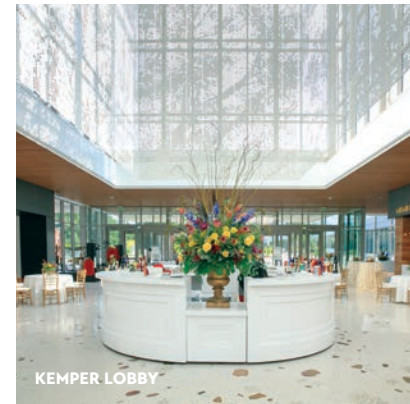

KEMPER LOBBY



SASSAFRAS RESTAURANT

Separate rental fee required for some decor and seating.





LEILA J. AND DAVID N. FARR AUDITORIUM

Perfect for weddings or lectures, this sophisticated auditorium can also be customized to accommodate dining and cocktail receptions in the same warm and welcoming space as your event. Add a stage or platform to elevate your event.

SQUARE FEET: 1065

Partitioned Room Side A: 568sf
Partitioned Room Side B: 569sf

CAPACITY: 150

Seated Lecture: 150
Seated With Tables: 36 or 16

AVAILABILITY

Sunday–Saturday: \$750
Inquire about room split capabilities.

AUDIO/VISUAL

Technology capabilities
and support available

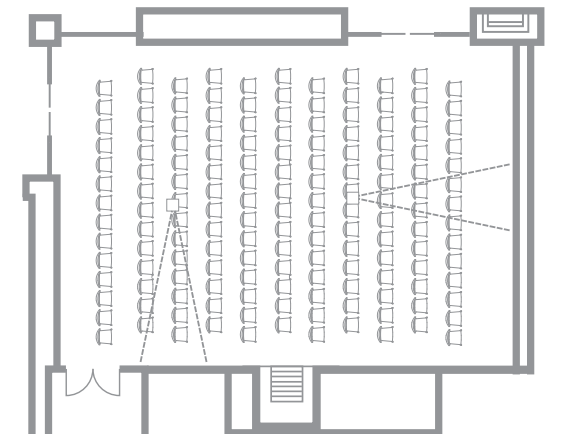
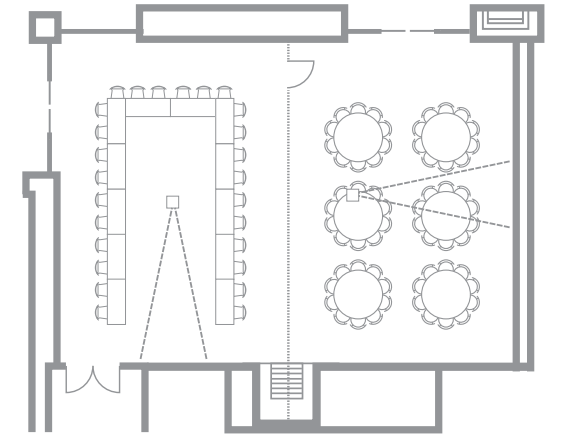



EAST AND WEST MEETING ROOMS

These multi-functional meeting spaces feature state-of-the-art video and audio systems, customizable sizing, and conveniences like whiteboard walls for presentations and capturing ideas.

SQUARE FEET: 1065

Partitioned Room Side A: 568sf
Partitioned Room Side B: 569sf

CAPACITY: 72

Seated: 72
Seated with Tables: 36 or 16

AVAILABILITY

Monday–Sunday
Combined: \$500
Split: \$300

AUDIO/VISUAL

Technology capabilities
and support available

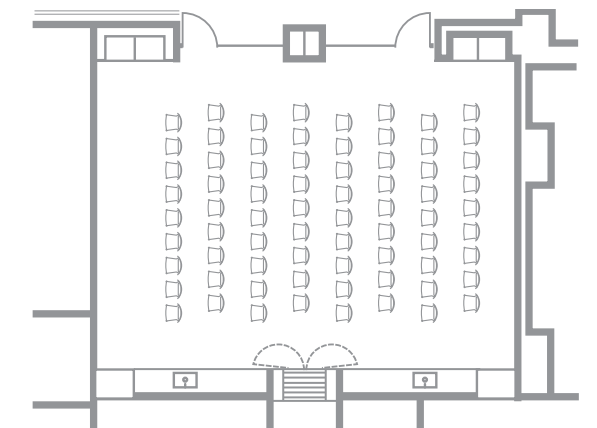
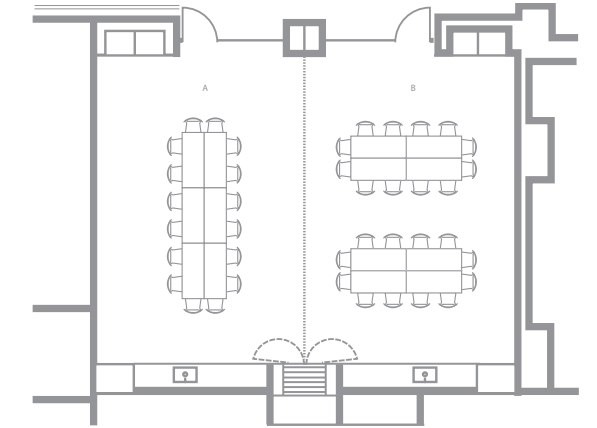



WILLIAM T. KEMPER LOBBY

Filled with dappled natural light and breathtaking views of the Garden.
(Special Exception Only)



SASSAFRAS RESTAURANT

Ideal for corporate dinners, our signature restaurant offers delectable cuisine and both indoor and outdoor seating areas with phenomenal views of the Garden.





SPINK PAVILION

Designed as the original entrance to the Missouri Botanical Garden, the historic Spink Pavilion is an ideal location for large weddings and corporate events. Situated on the Garden's Central Axis, the venue will delight your guests with beautiful views of reflecting pools filled with colorful water lilies, all surrounded by the Garden's natural splendor. Spink Pavilion can hold up to 150 guests and features a private entrance, an outdoor patio perfect for receptions, an indoor cocktail area, and a private bridal room.



CAPACITY: 150

Buffet Seated: 60
Seated: 90

AUDIO/VISUAL

Technology capabilities
and support available

AVAILABILITY

Day Facility Rental

Monday–Friday: \$500
Saturday: \$2,500
Sunday: \$1,500

Evening Facility Rental

Monday–Wednesday: \$750
Thursday–Friday: \$2,000
Saturday: \$2,500
Sunday: \$1,500

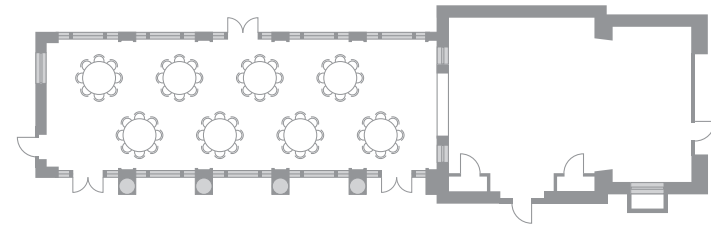



WEDDING VENUES

Situated throughout the Missouri Botanical Garden you'll discover six idyllic wedding venues, perfect for any type of ceremony you and your family desire. After your unforgettable wedding in one of these lovely Garden locations, Bayer Event Center or Spink Pavilion are ideal venues for your reception.

CAPACITY: 25-300

Lehmann Rose Garden: 150 Seated Guests In The Round

Gladney Rose Garden: 150 Seated Guests

Blanke Boxwood Garden: 50 Guests (10 Seated, 40 Standing)

Grigg Nanjing Friendship Chinese Garden: 25 Standing Guests

Japanese Garden: 300 Seated Guests

Linnean Plaza: 300 Seated Guests

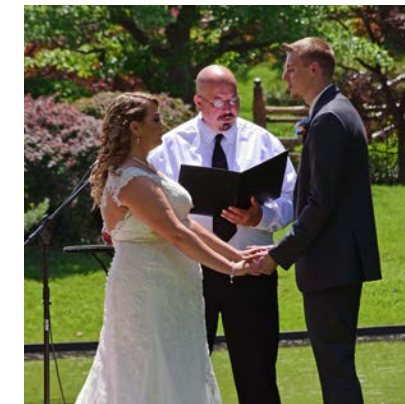
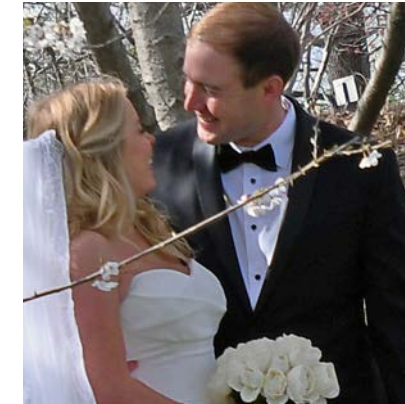



LEHMANN ROSE GARDEN

Featuring an absolutely stunning winding walkway, this venue is surrounded by hundreds of fragrant roses and aromatic flowering plants. Located in the heart of the Garden, your ceremony here will take place in a grand gazebo, with an elegant fountain as your backdrop.

Capacity: 150 Seated Guests
In The Round

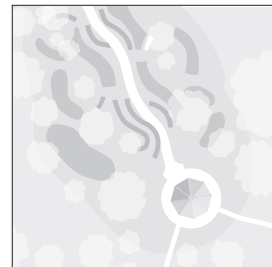

GLADNEY ROSE GARDEN

The Gladney Rose Garden is famous for its climbing roses, beautiful arbors, and the old-fashioned white fence that surrounds it all. Conveniently located near the main entrance to the Garden, this charming venue also includes two of the Garden's graceful and elegant Chihuly glass sculptures (displayed seasonally).

Capacity: 150 Seated Guests

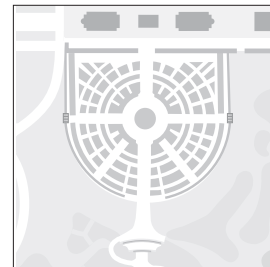

BLANKE BOXWOOD GARDEN

Perfect for small, intimate ceremonies, the charming Blanke Boxwood Garden features a beautiful display of immaculate boxwoods and perennials. Whimsical fountains provide a delightful backdrop to your wedding here. This secluded venue is located at the heart of the Garden.

Capacity: 50 Guests
(10 Seated, 40 Standing)

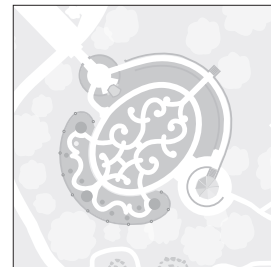

GRIGG NANJING FRIENDSHIP CHINESE GARDEN

Considered the most authentic "scholar's garden" of its size in the United States, the Grigg Nanjing Friendship Chinese Garden will create a one-of-a-kind experience for you and your wedding guests. The graceful pavilion architecture results from extraordinary craftsmanship, and a hand-carved white marble bridge spans a small bubbling stream, creating a romantic and truly unique environment.

Capacity: 25 Standing Guests

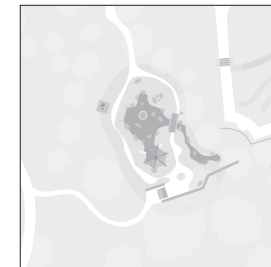

JAPANESE GARDEN

Seiwa-En, the Japanese Garden, is one of the most photographed locations in all of the Garden, and for good reason. Your wedding ceremony here will overlook a serene 4-acre lake featuring a historic footbridge. With more than 14 pastoral and peaceful acres, this venue can accommodate both large and small weddings.

Capacity: 300 Seated Guests



LINNEAN PLAZA

Nestled between Kooyumijian Family Event Terrace and the historic Linnean House conservatory, this adaptable space is bordered by pleasant views of the Bakewell Ottoman Garden to the East and the expansive South Gardens to the West.

Capacity: 300 Seated Guests

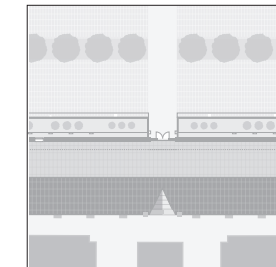

**THE NATURAL
CHOICE FOR
YOUR EVENT.**



The Missouri Botanical Garden is committed to helping you create the event of your dreams, regardless of your purpose or scope. For more information, or to tour our Garden, please visit mobot.org/privateevents



OUR MISSION

To discover and share knowledge about plants and their environment in order to preserve and enrich life.



MISSOURI
BOTANICAL
GARDEN

4344 Shaw Blvd, St. Louis, MO 63110 • (314) 577-0200

Photography by Suzy Gorman

©2024 Missouri Botanical Garden. All Rights Reserved.